

# Hippos (Sussita) Excavations 2010 – 11th Season Daily Log + Drawing

Date: 14 July 10 Area: NEC Manager: Schuler

Squares	XXYY99	YY/ZZ1/2	YY/ZZ4	YYZZ01	
Loci	1226 1905 1907 1296	1226	1906 1906	1226	
Baskets	2341 2342 2343 2348	2345	2346 2347	2344	
Walls	W1261, W1266, W1288, W1236, W1297, W1298, W1902, W1903, W1904				
Floors	F1294				

- Continued work in XXYY99
  - Goal = Searching for intersection between W1266 and north to south wall on west side of putative street.
  - Starting elevation = 130.779 (average), 130.230 (south vat), 130.794 (north vat)
  - Ending elevation = 130.580, 129.804 (southern vat), 130.120 (top of cistern head in vat), 130.794 (step? next to north vat), 130.997 (top of W1266)
  - Soil is Horizon B
  - Discovered a step or front supporting shelf for west side of north vat. The top of the “step” is 23 cm below the top of the wall. It has been exposed to a depth of 5t6 cm below the top of the wall, so the step/shelf is at least 32cm high
  - Approaching floor in south vat, as surviving plaster is curving in. The floor seems to be about 1.5m below the top of the vat

- Removed a portion of a column that fell to the south east and crushed the vest side of the vat. Perhaps the column was a survivor of the six projected to be on the stylobate in ZZ99 (second from the east?).
- A cistern head from a hollowed out column drum or an hour-glass-shaped mill (also called "Pompeiiian") sits on the floor (?) of the vat. It is 45cm in external diameter and 24cm internally slanting to that diameter over 15 cm. It is 35cm from the southern wall, 101 cm from the east wall and 46cm from the north wall.
- W1266 has been exposed to a depth of 54cm on its northern face. It is tilting northward approximately 6cm over that distance.

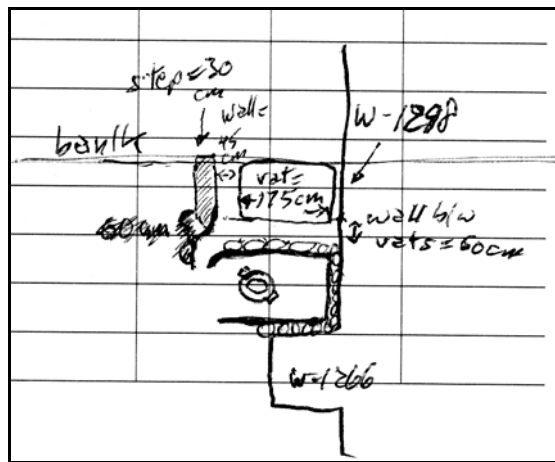

- Continued work in square YZZ0/1
  - Goal = Expose rest of the paved plaza east of the church
  - Starting elevation = 130.961 (average), 131.064 (wall section in NE corner of square).
  - Ending elevation = 130.919
  - Soil is Horizon B
  - Removed heavy destruction fill, especially to the west, including two column drums (37cm in diameter and 35cm high, 35cm in diameter and 26 cm high).
  - Discovered a cistern in the paved plaza. Its head is a column drum that has been hollowed out. The inner diameter of the head is 37cm with the wall about 6cm thick. The drum was originally about 50cm in diameter. It is located 1.2m from the north edge of the south stylobate and 4.2m from W1267.

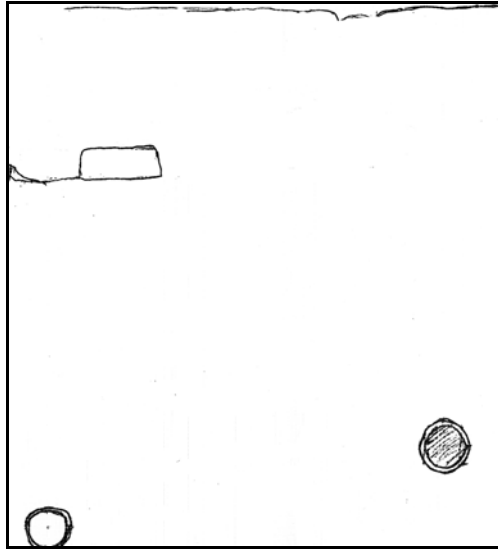

- Basket 2344 is from Locus 1226. That locus is the middle part of peristyle court : above the pavement. In general, the contents are large fragments of Beisan jars and BYZ casseroles, 1 lamp fragment, dating from 450 AD until 650 AD. Indicative types are LRC.
- Item: 480. Description: nail (11 cm long, head 18 mm diam, body 1 cm wide) removed 827 cm east of w1267, 122 cm north of yy 0 / yy 1 line, 70 cm from the surface.
- Continued work in Square YY/ZZ1/2
  - Goal = Follow W1261 and south stylobate of paved plaza to the east.
  - Starting elevation = 130.804 (high), 130.043 (stylobate)
  - Ending elevation = 130.695 (fill), 130.499 (threshold of doorway in W1261), 130.048 (east side of stylobate)
  - Soil is Horizon C
  - Discovering drain tile in the fill.
  - Stopped excavating from west to east and shifted to top down excavation on the east part of the square
  - The stylobate turn to the north at the second column from the west
  - The inside edge of this north to south stylobate is 5.0m from W1267
  - Thought: the area to the east of the stylobate may have some domestic or secondary reuse.

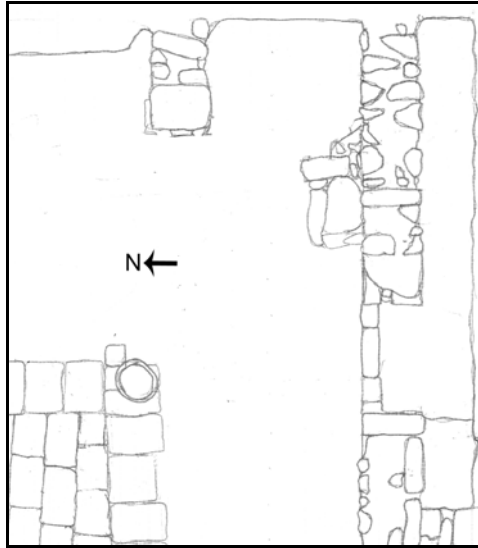

- Basket 2345 is from Locus 1226. That locus is S. part of peristyle court. In general, the contents are large pieces of Beisan jars, AMP (look for additional fragments of it in B.2338) and some cooking pots, dating from 450 AD until 600 AD. Indicative types are ARS. Residual types are 1 ESA.
- Item: 475. Description: nail in 3 pieces: piece 1 largest piece (head): 5.5 x 1 x 2 cm, piece 2: 'l' shaped body: 5 cm x .5 cm, piece 3: 'j' shaped tip: 4 cm x .8 cm x .4 cm, found just inside the west door jam of w1261, 149 cm from surface.
- Item: 476. Description: nail (length 14 cm, width .5 cm to .8 cm, diam of head 1.0 cm) found just inside the east door jam of w1261, 149 cm from surface.
- Item: 477. Description: bent nail (length 10 cm, head 2 cm diameter, width 8mm to 1 cm) recovered 28cm west of east door jamb in W1261, at 149cm from the surface.
- Item: 478. Description: Nail (11 cm long but bend at 7.5 cm, head 1.5 cm diam, body 7 mm to 1 cm wide) discovered just inside the west door jam of w1261, 149 cm from the surface.
- Item: 481. Description: Floor tile, carved. Upper portion has left and lower arm of a byzantine cross, possible circle surrounding the cross. Lower portion has engraved 't' shaped, ca. 2.5 cm to 3.0 cm wide. Size: width 14.0 cm, height 16.5 cm (left side), height 09.0 cm (right side), thickness 2.0 cm.

Excavated 340 cm east of w1267, 270 cm north of (north half) of yy 1, 128 cm from surface.

- Item: 485. Description: metal rod or nail (6 cm long, 0.5 cm wide) from 710 cm east of w1267, 114 cm north of (north half) of yy 1, 98 cm from surface.
- Item: 487. Description: Metal, twisted with 2 of 3 'legs' present. Top is rolled into a cylinder (3 cm long, 1 cm wide) retrieved 276 cm east of stylobate, 20 cm south of eastern door jamb, 132 cm from surface.
- Item: 489. Description: carved bone (jewelry?), cylindrical shape with two ridges, circular pattern of eyelets around top and bottom (evil eye?), center is hollow, 4 cm tall, 2.5 cm diameter, discovered 286 cm north of w1261, 25 cm from east balk, 125 cm from surface.
- Continued work in Square YY/ZZ4
  - Goal = Follow W1288 and W1236 to east and clarify temporal relationship.
  - Starting elevation = 131.085
  - Ending elevation = 130.840, 131.042(?) (courtyard east of threshold), 131.000 (threshold in W1904), 130.823 (flat stone, possible level of floor)
  - Soil is Horizon C
  - Continued to remove fill from inside the room as team approaches floor.
  - Possible long and narrow beads of a necklace discovered near the entrance to the room.
  - Soil is becoming moister, indicating we may be approaching a floor.
  - Area east of W1904 will be excavated more fully when the square to the east is opened. The area seems to be an outdoor court with crude (uncut) paving stones.
  - Began cleaning top of W1288 and clarifying the north edge of the wall.
  - Basket 2346 is from Locus 1906. That locus is a room in square ZZ/ 4. In general, the contents are large pieces of Beisan jars, some cooking ware, dating from 350 AD until 600 AD. Indicative types are CRS.
  - Basket 2347 is from Locus 1906. That locus is Above the floor in the square YZZ4 in the W1904; near entrance in W1904 (where the maenad sculpture was found). In general, the contents are fragments of Beisan jars, dating from 500 AD until 600 AD.

- Item: 479. Description: nail in three (3) pieces (piece 1: 5.5 cm l x .5-1.0 cm wide; piece 2: 2.5 cm l x 1.0 cm wide; piece 3: 3 cm l x .5-.7 cm wide (tip)) discovered 102 cm from w1288 extension, 45 cm east of w1904, 182 cm from surface.
- Item: 482. Description: two (2) pieces of a nail (head: 2 cm diam; body: 9 cm l x 1.5-2.0 cm wide) discovered 114 cm south of w1288 extension, 43 cm east of w1904, 185 cm from surface.
- Item: 483. Description: nails: one complete and 2 fragments (nail 1: 12 cm long, 0.7-1 cm wide; frag 1: 5.5 cm long, 1 cm wide (partial head 2 cm diam); frag 2: 5.0 cm long, 2.5 cm wide (looks like two pieces stuck together)) discovered 125 cm south of w1288 extension, 56 cm east of w1904, 187 cm from surface.
- Item: 484. Description: coin just over 2 cm in diameter, highly corroded, retrieved 54 cm south of w1288, 135 cm east of w1270, 182 cm from surface.
- Item: 486. Description: fibula (broach). On the front is a cross shaped pattern. The bottom has a pattern of eyelets. Spring and pin are still intact on back. Size: 8 cm long, 5 cm at cross, 1 cm wide for each arm discovered 77 cm south of w1288, 300 cm east of w1270, 230 cm from surface
- Conservation of plaster in ZZ99 begun.