

# Hippos (Sussita) Excavations 2003 – 4th Season Daily Log + Drawing

Date: 21 July 2003 Area: NEC Manager: Schuler

Squares	D3	D3	B2A	B3
Loci	L501	L524	L531	L529
Baskets	PC1857	PC1856	PC1859	PC1860
Walls	W510			
Floors	F516, F517, F526			

- Continued work in Square D3
  - Starting elevation = 131.23
  - Ending elevation = 130.78
  - The soil of L501 is Horizon B: grayish brown (10YR 5/2) dry, very stony sandy loam, dark grayish brown (10YR 4/2) moist; very weak, coarse subangular blocky structure; 10 percent pebbles, 15 percent cobbles, 35 percent stones; irregular boundary. The soil of L524 is Horizon C -- dark grayish brown (10YR 4/2) dry, very stony sandy loam, very dark brown (10YR 2/2) moist; weak fine granular structure; friable; 10 percent pebbles, 15 percent cobbles, 30 percent stones; clear wavy boundary.
  - List of architectural items
    - 068 Limestone doorjamb from L501 in the balk

---

<b>Basket</b>	<b>Area</b>	<b>Locus</b>	<b>Square</b>	<b>Opening elevation</b>
1856	NEC	L524	D3	130.9
<b>Closing Elevation</b>		<b>Weight</b>	<b>Date</b>	<b>Manager</b>
130.78		0.25	21-Jul-03	Schuler
Yes <b>Ceramic</b>	No <b>Plaster</b>	No <b>Human Bones</b>		
No <b>Ceramic non-pottery</b>	No <b>Architectural Item</b>	No <b>Iron</b>		
Yes <b>Tessera</b>	No <b>Lamp</b>	No <b>Lead</b>		
No <b>Glass</b>	No <b>Inscription</b>	No <b>Inscription</b>		
<b>Remarks</b>				
final reading incomplete				
<b>FW Bowl/Plate Base</b>	<b>FW Bowl/Plate Rim</b>	<b>FW Bowl/Plate Handle</b>	<b>FW Bowl/Plate Body Shard</b>	
0	0	0	0	
<b>FW Juglet Base</b>	<b>FW Juglet Rim</b>	<b>FW Juglet Handle</b>	<b>FW Juglet Body Shard</b>	<b>CCW Pot Base</b>
0	0	0	0	0
<b>CCW Pot Rim</b>	<b>CCW Pot Handle</b>	<b>CCW Body Shard</b>	<b>CCW Casserole Base</b>	<b>CCW Casserole Rim</b>
0	0	3	0	0
<b>CCW Casserole Handle</b>	<b>CCW Bowl Base</b>	<b>CCW Bowl Rim</b>	<b>CCW Bowl Handle</b>	<b>CCW Lid Base</b>
0	0	0	0	0
<b>CCW Lid Rim</b>	<b>CCW Lid Handle</b>	<b>OCW Jar Base</b>	<b>OCW Jar Rim</b>	<b>OCW Jar Handle</b>
0	0	0	0	0
<b>OCW Other Base</b>	<b>OCW Other Rim</b>	<b>OCW Other Handle</b>	<b>OCW Other Body Shard</b>	<b>Lamp Base</b>
0	0	0	0	8
<b>Lamp Rim</b>	<b>Lamp Handle</b>	<b>Lamp Body Shard</b>		
0	0	0		

0 0 0

**Analysis**

Tesserae:

1 cm -- 1 white, 1 black

1.5cm -- 21 white, 1 black

---

<b>Basket</b>	<b>Area</b>	<b>Locus</b>	<b>Square</b>	<b>Opening elevation</b>
1857	NEC	L501	D3	131.23

**Closing Elevation**

130.9

**Weight**

1.96

**Date**

21-Jul-03

**Manager**

Schuler

**Loci Type**

destruction fill

Yes <b>Ceramic</b>	No <b>Plaster</b>	No <b>Human Bones</b>
Yes <b>Ceramic non-pottery</b>	Yes <b>Architectural Item</b>	No <b>Iron</b>
Yes <b>Tessera</b>	No <b>Lamp</b>	No <b>Lead</b>
No <b>Glass</b>	No <b>Inscription</b>	No <b>Inscription</b>

**Remarks**

final reading incomplete

<b>FW Bowl/Plate Base</b>	<b>FW Bowl/Plate Rim</b>	<b>FW Bowl/Plate Handle</b>	<b>FW Bowl/Plate Body Shard</b>
0	0	0	0

<b>FW Juglet Base</b>	<b>FW Juglet Rim</b>	<b>FW Juglet Handle</b>	<b>FW Juglet Body Shard</b>	<b>CCW Pot Base</b>
0	0	0	0	0

<b>CCW Pot Rim</b>	<b>CCW Pot Handle</b>	<b>CCW Body Shard</b>	<b>CCW Casserole Base</b>	<b>CCW Casserole Rim</b>
1	0	32	0	0

<b>CCW Casserole Handle</b>	<b>CCW Bowl Base</b>	<b>CCW Bowl Rim</b>	<b>CCW Bowl Handle</b>	<b>CCW Lid Base</b>
1	0	0	0	0

<b>CCW Lid Rim</b>	<b>CCW Lid Handle</b>	<b>OCW Jar Base</b>	<b>OCW Jar Rim</b>	<b>OCW Jar Handle</b>	<b>OCW Jar Body Shard</b>
0	0	0	0	0	26

<b>OCW Other Base</b>	<b>OCW Other Rim</b>	<b>OCW Other Handle</b>	<b>OCW Other Body Shard</b>	<b>Lamp Base</b>
0	0	0	0	0

<b>Lamp Rim</b>	<b>Lamp Handle</b>	<b>Lamp Body Shard</b>
0	0	0

**Analysis**

9 pieces of roof tile

tesserae:

1 cm -- 12 white

1.5cm -- 5 white, 1 black

2cm -- 3 white

- 
- Did a soil profile of the balk between C3 and D3 and then removed it.
  - The bench against W510 in C3 ends at a length of 4.01m
  - The stylobate continues between CS3 and CS4 although the quality of the construction is cruder. Some stones are reused building stones and run east to west. The stylobate disappears west of CS4.
  - Continued work in Square B3
    - Starting elevation = 130.88
    - Ending elevation = 130.78
    - Soil in L529 is redder than others cited and compacted. It underlays the plaster base of F516.

---

<b>Basket</b>	<b>Area</b>	<b>Locus</b>	<b>Square</b>	<b>Opening elevation</b>
1860	NEC	L529	B3	130.88

BBBBB

<b>Closing Elevation</b> 130.78	<b>Weight</b> 1.7	<b>Date</b> 21-Jul-03	<b>Manager</b> Schuler	<b>Loci Type</b> sealed under floor
Yes <b>Ceramic</b>	Yes <b>Plaster</b>	No <b>Human Bones</b>		
No <b>Ceramic non-pottery</b>	No <b>Architectural Item</b>	No <b>Iron</b>		
Yes <b>Tessera</b>	No <b>Lamp</b>	No <b>Lead</b>		
No <b>Glass</b>	No <b>Inscription</b>	No <b>Inscription</b>		

**Remarks**

final reading incomplete

<b>FW Bowl/Plate Base</b>	<b>FW Bowl/Plate Rim</b>	<b>FW Bowl/Plate Handle</b>	<b>FW Bowl/Plate Body Shard</b>		
0	0	0	0		
<b>FW Juglet Base</b>	<b>FW Juglet Rim</b>	<b>FW Juglet Handle</b>	<b>FW Juglet Body Shard</b>	<b>CCW Pot Base</b>	
0	0	0	0	0	
<b>CCW Pot Rim</b>	<b>CCW Pot Handle</b>	<b>CCW Body Shard</b>	<b>CCW Casserole Base</b>	<b>CCW Casserole Rim</b>	
0	0	25	0	0	
<b>CCW Casserole Handle</b>	<b>CCW Bowl Base</b>	<b>CCW Bowl Rim</b>	<b>CCW Bowl Handle</b>	<b>CCW Lid Base</b>	
0	0	0	0	0	
<b>CCW Lid Rim</b>	<b>CCW Lid Handle</b>	<b>OCW Jar Base</b>	<b>OCW Jar Rim</b>	<b>OCW Jar Handle</b>	<b>OCW Jar Body Shard</b>
0	0	0	2	0	24
<b>OCW Other Base</b>	<b>OCW Other Rim</b>	<b>OCW Other Handle</b>	<b>OCW Other Body Shard</b>	<b>Lamp Base</b>	
0	0	0	0	0	
<b>Lamp Rim</b>	<b>Lamp Handle</b>	<b>Lamp Body Shard</b>			
1	0	0			

**Analysis**

4 pieces of marble

tesserae:

blocks-- 1 w 5 black, 1 w 6 white, 1 w 3 black and 4 white, 1 w 3 black and 2 white, 1 w 1 black and 1 white, 1 w 2 black and 2 white and 1 rose

loose:

1 cm -- 2 yellow, 4 red, 82 white, 43 black

1.5cm -- 1 red, 2 black, 2 white

- 
- Cleared L529 to the level of the plaster of F517. Revealed a small section of mosaic approximately 1m east to west and 20-34cm north to south next to W510 beginning 0.9m from the interior SE corner. Level is 130.78
  - Removed and number .5m of the tiles of F516 on the north side of the sarcophagus.
  - Resumed work in Square B2A
    - Starting elevation = 130.93
    - Ending elevation = 130.53
    - Below the floor in square B2A, the soil was redder in color and more compacted. It appeared to be more developed but not enough was observed to make a detailed examination. The lighter colored C horizon lies on the floor of the church. The lower soil dug more easily.
    - List of architectural items
      - second tomb (see below)
-

<b>Basket</b> 1859	<b>Area</b> NEC	<b>Locus</b> L531	<b>Square</b> B2A	<b>Opening elevation</b> 130.93
<b>Closing Elevation</b> 130.53	<b>Weight</b> 0.75	<b>Date</b> 21-Jul-03	<b>Manager</b> Schuler	<b>Loci Type</b> destruction fill
Yes <b>Ceramic</b>	Yes <b>Plaster</b>	No <b>Human Bones</b>		
No <b>Ceramic non-pottery</b>	No <b>Architectural Item</b>	No <b>Iron</b>		
Yes <b>Tessera</b>	No <b>Lamp</b>	Yes <b>Lead</b>		
No <b>Glass</b>	No <b>Inscription</b>	No <b>Inscription</b>		

**Remarks**

under floor level but not sealed; final reading incomplete

<b>FW Bowl/Plate Base</b>	<b>FW Bowl/Plate Rim</b>	<b>FW Bowl/Plate Handle</b>	<b>FW Bowl/Plate Body Shard</b>
0	0	0	0

<b>FW Juglet Base</b>	<b>FW Juglet Rim</b>	<b>FW Juglet Handle</b>	<b>FW Juglet Body Shard</b>	<b>CCW Pot Base</b>
0	0	0	0	0

<b>CCW Pot Rim</b>	<b>CCW Pot Handle</b>	<b>CCW Body Shard</b>	<b>CCW Casserole Base</b>	<b>CCW Casserole Rim</b>
0	0	34	0	0

<b>CCW Casserole Handle</b>	<b>CCW Bowl Base</b>	<b>CCW Bowl Rim</b>	<b>CCW Bowl Handle</b>	<b>CCW Lid Base</b>
0	0	0	0	0

<b>CCW Lid Rim</b>	<b>CCW Lid Handle</b>	<b>OCW Jar Base</b>	<b>OCW Jar Rim</b>	<b>OCW Jar Handle</b>	<b>OCW Jar Body Shard</b>
0	0	0	0	1	29

<b>OCW Other Base</b>	<b>OCW Other Rim</b>	<b>OCW Other Handle</b>	<b>OCW Other Body Shard</b>	<b>Lamp Base</b>
0	0	0	0	0

<b>Lamp Rim</b>	<b>Lamp Handle</b>	<b>Lamp Body Shard</b>
0	0	0

**Analysis**

2 pieces of marble

Tesserae:

1 cm -- 5 red, 34 white, 12 black

- A significant sounding from a metal detector motivated probes in the section of B2 where no floor tiles were located.
- Just north of the east/west axis of the church is a partially collapsed tomb (Square B2A) topped with 5-6 stone slabs. To tomb is collapsed on the east end.
- The covering stones (basalt) are 17cm below the level of F516. They are approx 120 cm long. The widths vary (from west to east):
  - 40 cm
  - 36 cm
  - 40 cm
  - 30 cm broken and collapsed
  - limestone blocks fill the remainder of the tomb
- Between the second and third covering stones (for the west), a lead pipe protrudes. Its funnel opening is 7.5cm. The pipe is about 3.5cm in diameter. It is held above the covering stones by plaster (35x25x6 cm). The top of the lead pipe is approximately 10cm below the level of F516.

### Observations

Key question is the relation of the second tomb to the church. In particular, it is a secondary addition. The issue is raised due to the level of the lead pipe. The level of F516 is 103.3. The level of the plaster of F517 is 130.73. But the mosaic of F517 next to W510 is 130.78 and the level of the lead pipe is 130.82.

Daily Drawing 21 July

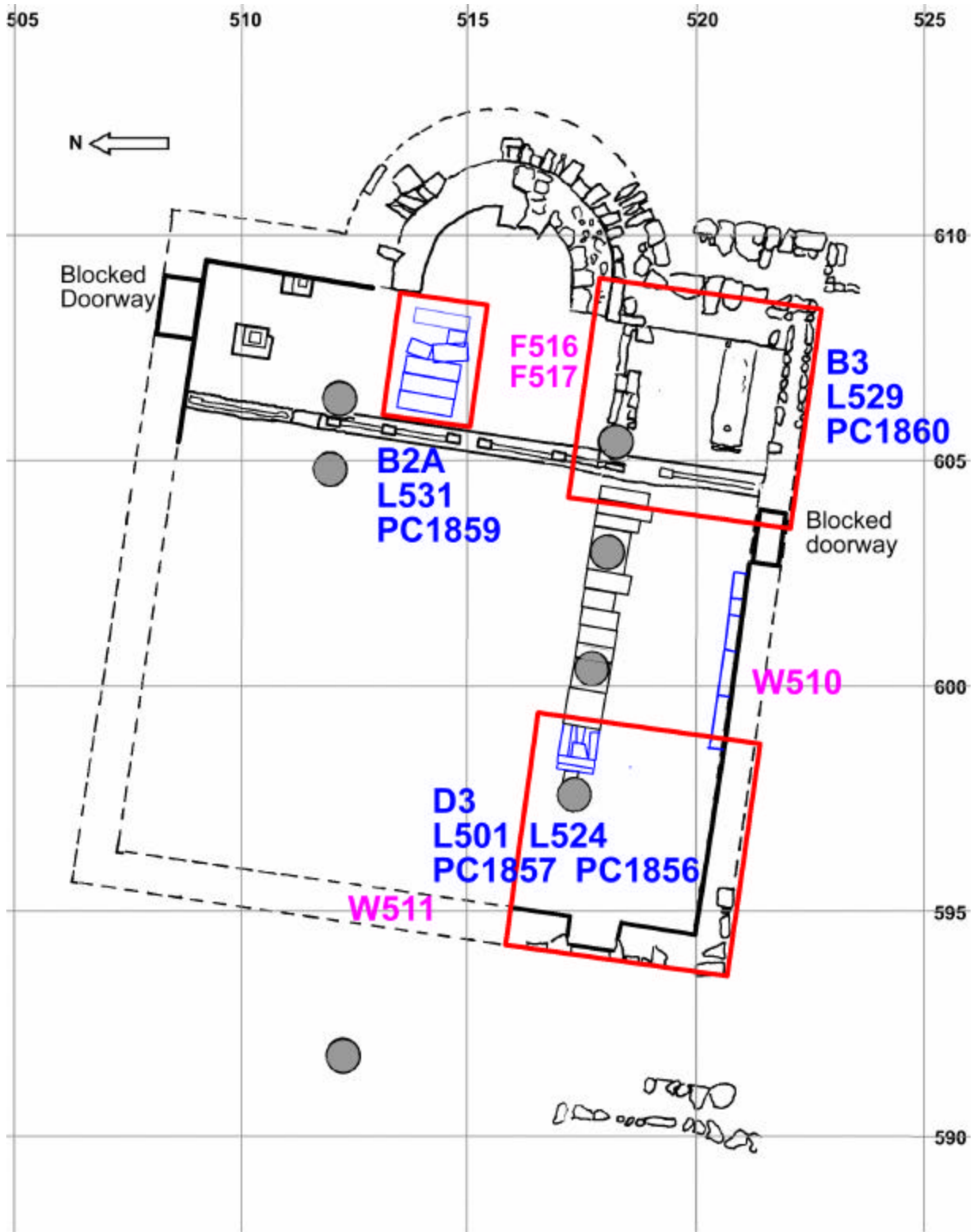

BBBBB